

CATALOG NUMBER	TYPE
PROJECT	

5" PREMIUM DOWNLIGHT TRIM **R5VT-41**

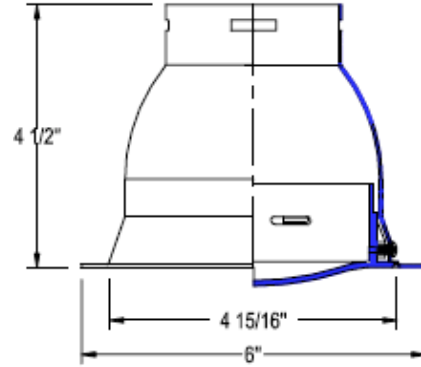

Ordering Matrix		
Series	Model Number	Finish
[]	[]	[]
R5VT	41	WT

Ordering Example (series – model number – finish): R5VT-41-WT

Product Details	Specification Features
<p>Application: Wall wash down light trim, 1-inch maximum ceiling thickness. The white “kicker” reflector intensifies the smooth wash of illumination with minimal glare, Used with incandescent or fluorescent lamp housings.</p> <p>Materials: One-piece spun aluminum construction. Integral trim ring and kicker are painted white. Trim is retained to socket via spring clips.</p> <p>Finish: WT = White baffle with White trim</p> <p>Ratings: UL & CUL listed.</p>	<ul style="list-style-type: none"> Suitable for damp locations 5 year WAC Lighting product warranty.

Compatible Housings (sold separately)					
<p>R5VI-ICA Insulation Contact & Air Tight New Construction Incandescent Lamp: PAR20 50W</p>		<p>R5VI-R-ICA Insulation Contact & Air Tight Remodeling Incandescent Lamp: PAR20 50W</p>		<p>R5VI Non IC Frame-in Style New Construction Incandescent Lamp: PAR20 50W</p>	
<p>R5VF-113Q Non IC Frame-in Style New Construction Fluorescent Lamp: Quad 13W GX24Q-1</p>		<p>R5VF-126/32T Non IC Frame-in Style New Construction Incandescent Lamp: Tri-tube 26/32W GX24Q-3</p>			

CATALOG NUMBER	TYPE
PROJECT	

5" PREMIUM DOWNLIGHT TRIM **R5VT-41**

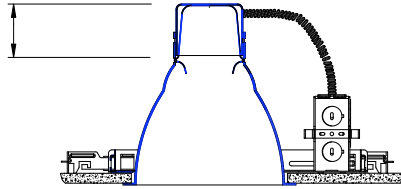

Socket cup adds a maximum of 2 1/8" to the height of the trim when used with frame in kits.