

**PALOMA SPOT –METAL HALIDE TRACK HEAD**

**SERIES WTK-530**

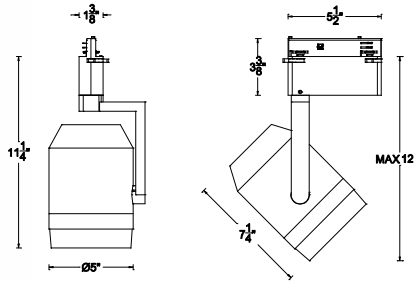

**WTK-530-39E**

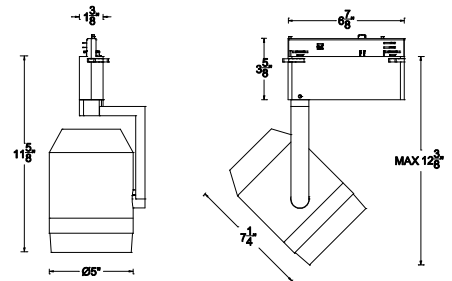

**WTK-530-70E**

**Ordering Matrix**

Model	Wattage	Finish
[ ]	[ ]	[ ]
WTK-530	39E =39W 70E =70W	BK = Black WT = White PT = Platinum

Ordering Example (model – finish ): WTK-530–39E-PT

**Product Details**

**Description:** HID Metal Halide track head using HID PAR30L lamps. Model WTK-530 Designed for use on WAC ARCHITECTURAL tracks(120V). Adaptable to other manufacturer's track. (Consult factory for specific brands).

**Materials:** Die-cast aluminum fixture, cap ring.  
Clear 1/8 inch tempered glass lens included.

<b>Ballast:</b>	<u>39W</u>	<u>70W</u>
<b>( VS )</b>	ANSI # : M130	M139
	Line Current : 0.38 Amps	0.64 Amps
	Input Power : 45W	77W
	Input Voltage : 120V	120V
	Power Factor : > 90%	> 90%
	Sound Rating : A	A

End of Lamp life detection and shut down circuit.

**Socket:** Ceramic HID E26

**Aiming:** 365° horizontal rotation and 180° vertical aiming to secure the aiming adjustment on horizontal .

**Lamping:** Re-lamps from the front using HID PAR30L (long) lamps, 39W or 70W as specified on the fixture. Lamp not included.

**Finish:** Powder coat paint finish.  
Available in Black (BK), White (WT), Platinum (PT).

**Listing:** UL & CUL Listed. Patent Pending.

**Specification Features**

- Die-cast aluminum fixture.
- Spring sheet within lens cap allows 4 captive accessories to be held securely.
- The track head utilizes on the WAC ARCHITECTURAL style track(120V) .
- 5 year product warranty.

## Compatible Accessories –USE SIZE 30

• **Dichroic Lens**  
LENS-30-DIC-COLOR

• **UV Filter**  
LENS-30-UV

• **IR Filter**  
LENS-20-IR

• **UV- IR Filter**  
LENS-30-UI

• **Beam Elongator**  
LENS-30-BEL

• **Beam Soft Lens/Beam Spread Lens**  
LENS-30-BSL / LENS-30-SPR

• **Block Screen**  
LENS-30-3-BS/ LENS-30-4-BS/ LENS-305-BS

• **Hood (for wall-washing)**  
HOOD-30-BK

• **Cross Louver**  
LENS-302-CRL

• **Snoot**  
LENS-30-SNOOT

• **Honeycomb Louver**  
LENS-302-HCL

## Photometry

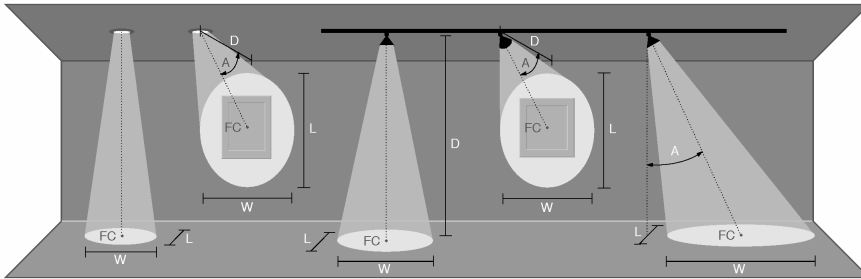

D Distance To Fixture From Wall Or Floor  
FC Initial Footcandle Level At Center Of Beam  
L Beam Length (where candlepower drops to 50% of maximum)  
W Beam Width (where candlepower drops to 50% of maximum)

39W HID PAR30L SP (24 DEG)			
0° Aiming Angle			
D(ft)	FC	L	W
6	157	3.0	3.0
9	70	4.5	4.5
12	39	6.0	6.0
15	25	7.5	7.5
45° Aiming Angle			
D(ft)	FC	L	W
6	56	6.4	4.2
9	25	9.6	6.3
12	14	12.8	8.5
15	9	16.0	10.6

70W HID PAR30L SP (24 DEG)			
0° Aiming Angle			
D(ft)	FC	L	W
6	203	3.6	3.6
9	90	5.4	5.4
12	51	7.2	7.2
15	32	8.9	8.9
45° Aiming Angle			
D(ft)	FC	L	W
6	72	7.9	5.1
9	32	11.8	7.6
12	18	15.7	10.1
15	11	19.6	12.6

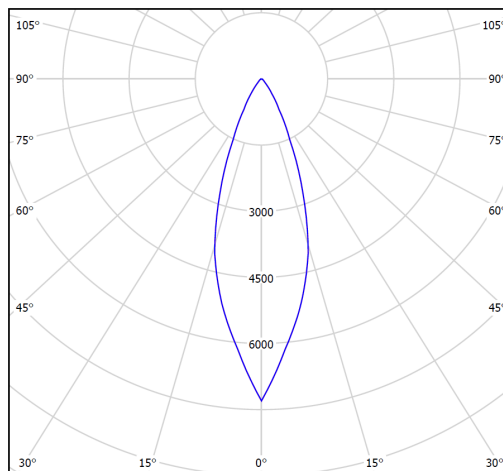
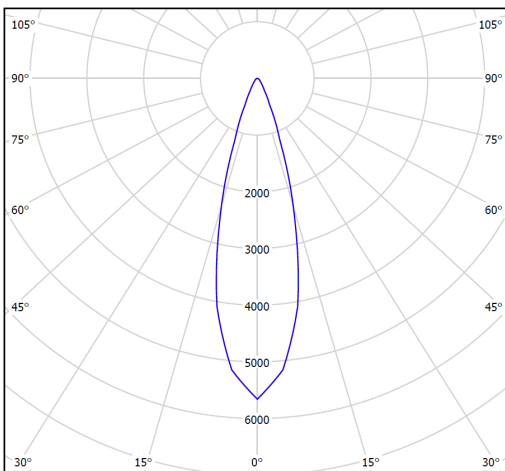

**PALOMA SPOT –METAL HALIDE TRACK HEAD**

**SERIES WHK-530**

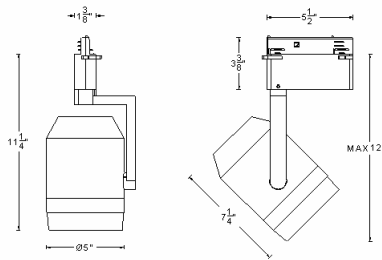

WHK-530-39E

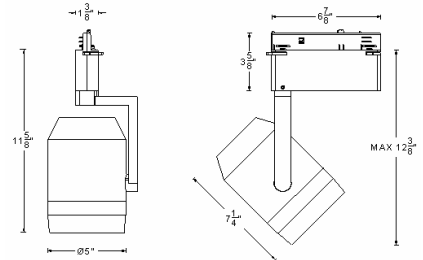

WHK-530-70E

**Ordering Matrix**

Model	Wattage	Finish
[ ]	[ ]	[ ]
WHK-530	39E =39W 70E =70W	BK = Black WT = White PT = Platinum

Ordering Example (model – finish ): WHK-530–39E-PT

**Product Details**

**Description:** HID Metal Halide track head using HID PAR30L lamps. Model WHK-530 Designed for use on WAC ARCHITECTURAL tracks(277V). Adaptable to other manufacturer’s track. (Consult factory for specific brands).

**Materials:** Die-cast aluminum fixture, cap ring.  
Clear 1/8 inch tempered glass lens included.

**Ballast:**

	<u>39W</u>	<u>70W</u>
<b>( VS )</b>	ANSI # : M130	M139
	Line Current : 0.16 Amps	0.28 Amps
	Input Power : 45W	77W
	Input Voltage : 277V	277V
	Power Factor : > 90%	> 90%
	Sound Rating : A	A

End of Lamp life detection and shut down circuit.

**Socket:** Ceramic HID E26

**Aiming:** 365° horizontal rotation and 180° vertical aiming to secure the aiming adjustment on horizontal.

**Lamping:** Re-lamps from the front using HID PAR30L (long) lamps, 39W or 70W as specified on the fixture. Lamp not included.

**Finish:** Powder coat paint finish.  
Available in Black (BK), White (WT), Platinum (PT).

**Listing:** UL & CUL Listed. Patent Pending.

**Specification Features**

- Die-cast aluminum fixture.
- Spring sheet within lens cap allows 4 captive accessories to be held securely.
- The track head utilizes on the WAC ARCHITECTURAL style track (277V) .
- 5 year product warranty.

## Compatible Accessories –USE SIZE 30

• **Dichroic Lens**  
LENS-30-DIC-COLOR

• **UV Filter**  
LENS-30-UV

• **IR Filter**  
LENS-20-IR

• **UV- IR Filter**  
LENS-30-UI

• **Beam Elongator**  
LENS-30-BEL

• **Beam Soft Lens/Beam Spread Lens**  
LENS-30-BSL / LENS-30-SPR

• **Block Screen**  
LENS-303-BS/ LENS-304-BS/ LENS-305-BS

• **Hood (for wall-washing)**  
HOOD-30-BK

• **Cross Louver**  
LENS-302-CRL

• **Snoot**  
LENS-30-SNOOT

• **Honeycomb Louver**  
LENS-302-HCL

## Photometry

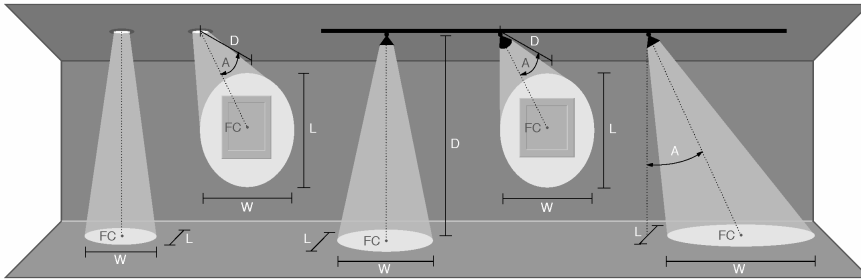

D Distance To Fixture From Wall Or Floor  
FC Initial Footcandle Level At Center Of Beam  
L Beam Length (where candlepower drops to 50% of maximum)  
W Beam Width (where candlepower drops to 50% of maximum)

39W HIDPAR30 SP (24 DEG)			
0° Aiming Angle			
D(ft)	FC	L	W
6	157	3.0	3.0
9	70	4.5	4.5
12	39	6.0	6.0
15	25	7.5	7.5
45° Aiming Angle			
D(ft)	FC	L	W
6	56	6.4	4.2
9	25	9.6	6.3
12	14	12.8	8.5
15	9	16.0	10.6

70W HIDPAR30 SP (24 DEG)			
0° Aiming Angle			
D(ft)	FC	L	W
6	203	3.6	3.6
9	90	5.4	5.4
12	51	7.2	7.2
15	32	8.9	8.9
45° Aiming Angle			
D(ft)	FC	L	W
6	72	7.9	5.1
9	32	11.8	7.6
12	18	15.7	10.1
15	11	19.6	12.6

