

INSTALLATION INSTRUCTION

Ovum, Charge, Portal LEDme® Quick Connect™ Fixtures

QF-LED101, QF-LED102, QF-LED103

WAC LIGHTING

Responsible Lighting®

OVERVIEW

QF-LED101, QF-LED102, QF-LED103 fixture is designed for use with WAC Quick Connect™ systems available in: Solorail(LM), Duorail(LM2), and Monopoint (QMP-), Line Voltage Track(H, J, L), Flexrail(HM1)

QUICK CONNECT™ ADAPTER (ORDER SEPARATELY)

Solorail (LM) Adapter: **LM-QADP**

Duorail (LM) Adapter: **LM2-QADP**

Flexrail1 (HM1) Adapter: **HM1-EN50**

Line Voltage Track (H, J, L) Adapter:

EN-HQ50AR, EN-JQ50AR, EN-LQ50AR

INSTALLING THE QUICK CONNECT:

1. Insert the post of the quick connect into the quick connect adapter.
2. Thread the top half of the conical section until it seats with the adapter.
3. Adjust fixture position, use caution not to loosen the conical section.

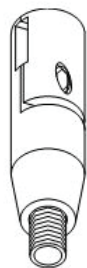
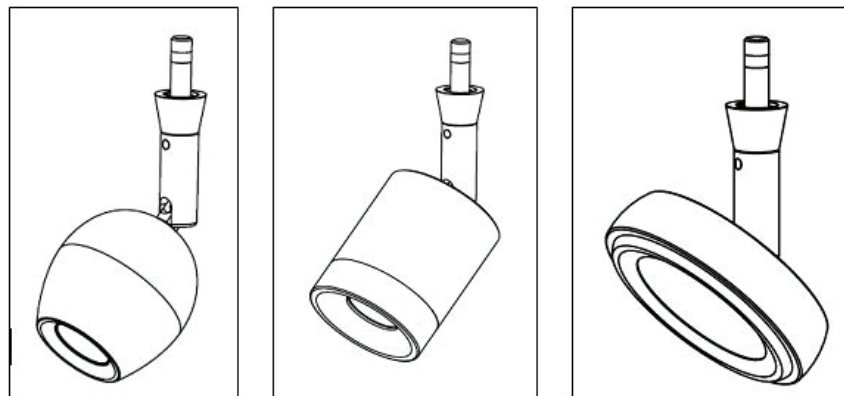

Example: Solorail Quick Connect Adapter

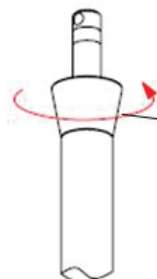

Top Conical Section

WAC Lighting

www.waclighting.com

Phone (800) 526.2588 • Fax (800) 526.2585

Headquarters/Eastern Distribution Center

44 Harbor Park Drive • Port Washington, NY 11050

Phone (516) 515.5000 • Fax (516) 515.5050

Western Distribution Center

1750 Archibald Ave • Ontario, CA 91761

Phone (800) 526.2588 • Fax (800) 526.2585